

Megatherm

The alternative way of heating

Wood - Pellet Burners

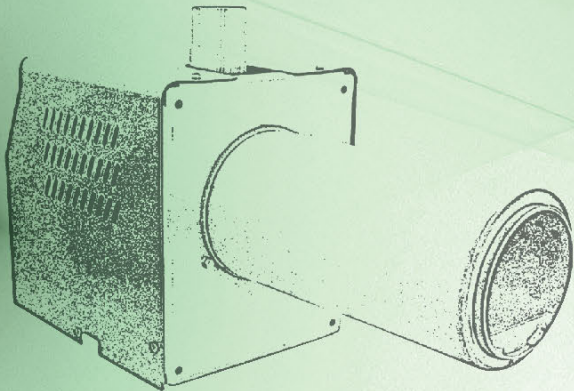

Megatherm's wood pellet burners work in the same philosophy with an oil or gas burner. Thanks to their construction with a forward burning flame will give the most effective combustion and they are easy to fit it to the most boilers on the market.

Megatherm's wood pellet burners have designed and developed to offer high efficiency(>95%), durability and environmental friendly operation (Low CO, NOx). Burner's fire tube is made by heat resistance stainless steel, which promises an outstanding lifetime. The operation of the burner is controlled by the latest technology electronic controller. The ignition of the burner is made automatically within few minutes (3-4min), by using a resistance as an igniter.

The ash is removed in a matter of seconds, by using the scrapper which is provided with the burner.

Applications

Megatherm's wood-pellet burners can be installed on:

- all pellet boilers
- all wood boilers
- most oil boilers
- most space heaters
- tobacco/fruit driers
- bakery ovens
- car's paint shop
- steam boilers

Controller

Burner's latest technology controller ensures the smooth and safe operation of the heating system. Compared with the most burners on the market, the controller is far more extensive in terms of function, possibilities and easy of use.

The controller is equipped with:

- LCD screen (2 x 20signs)
- 5 menus (A. Furnace settings, B. HUW settings, C. Burner settings, D. Device settings, E. Manufacturer settings)
- Twelve languages : English, Greek, Polish, German, French, Portuguese, Swedish, Dutch, Latvian, Lithuanian, Czech, Slovakian.
- Boilers/furnace temperature sensor, 0-120°C
- Boilers/furnace temperature sensor 0-1000°C (optional)



- HUW/buffer temperature sensor (optional)
- Electric cable for connecting CH pump
- Electric cable for connecting HUW/ buffer pump (optional)
- Room thermostat connection
- Vocal alarm outputs in case of an error
- Diagnosis of errors
- 4 Amp fuse for high voltage protection
- Built-in flash memory maintains programmed settings and safety functions in case of power failure
- Automatic restart of the burner in case of a power failure

Nani 35

- Ideal for private houses and small buildings
- The fire tube is made by high heat resistance stainless steel of 3 & 4mm thickness
- Made by high quality material
- Low installation and maintenance cost
- Automatic ignition
- Controls the temperature of the boiler/furnace
- Gradual increase of the burner's power in 3 steps
- Three ways of operation : single, continuous, analogue
- Photosensor for controlling the fire, by measuring the flame's density.
- Thermostat protecting the burner of overheating and back fire
- Connection for STB sensor, for overheating furnace/boiler
- Detecting possible malfunction of the temperature's sensors
- Automatic restart of the burner after power failure
- High combustion efficiency >95%
- Low emissions CO, NOx.
- The controller is located on the burner

Megatherm

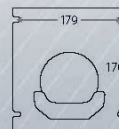
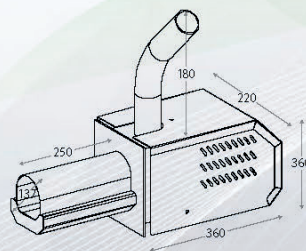

| | |
|--------------------------|-----------------------------------|
| Type | Nani 35 |
| Power | 10 - 35 kW 8.600 - 30.100 Kcal |
| Length | 610 mm |
| Width | 220 mm |
| Height with drop pipe | 400 mm |
| Height without drop pipe | 220 mm |
| Fire tube diameter | Φ 140 mm |
| Power supply | 230 Volt / 50 Hz |
| Igniter | 425 Watt |
| Electr. Consumption | 30 - 40 Watt (approx.) |
| Fuel | Wood pellet 6 - 8 mm, A' Class |
| Weight | 14 kg |
| Feeder's length | 1,5 m |

* Included on delivery: Burner Nani 35, feeder, plastic pipe connecting the burner with the feeder, scraper.

Megatherm

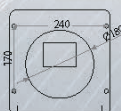
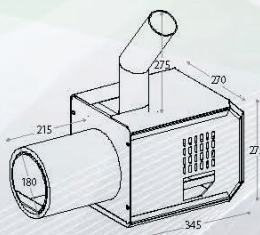

MPB 50

- Ideal for private houses, for small & medium buildings, bakery, ovens, driers, etc..
- Double wall fire tube (tube-in-tube) made by high heat resistance stainless steel of 3 & 5mm thickness
- Made by high quality material
- Low installation and maintenance cost
- Automatic ignition
- Controls the temperature of the boiler/furnace
- Gradual increase of the burner's power in 3 steps
- Three ways of operation : single, continuous, analogue
- Photosensor for controlling the fire, by measuring the flame's density.
- Thermostat protecting the burner of overheating and back fire
- Connection for STB sensor, for overheating furnace/boiler
- Detecting possible malfunction of the temperature's sensors
- Automatic restart of the burner after power failure
- High combustion efficiency >95%
- Low emissions CO, NOx.
- The controller is separated from the burner for increased safety
- High quality connector connecting controller with the burner

| | |
|--------------------------|------------------------------------|
| Type | MPB 50 |
| Power | 25 - 50 kW 21.500 - 43.000 Kcal |
| Length | 560 mm |
| Width | 270 mm |
| Height with drop pipe | 550 mm |
| Height without drop pipe | 275 mm |
| Fire tube diameter | Φ 180 mm |
| Power supply | 230 Volt / 50 Hz |
| Igniter | 425 Watt |
| Electr. Consumption | 40-50 Watt (approx.) |
| Fuel | Wood pellet 6-8mm, A' Class |
| Weight | 18 kg |
| Feeder's length | 1,5 m |

* Included on delivery: Burner MPB 50, electronic controller, feeder 1,5m, plastic pipe connecting the burner with the feeder, scrapper

MPB 80

- Ideal for private houses, for small & medium buildings, bakery ovens, driers, etc..
- Double wall fire tube (tube-in-tube) made by high heat resistance stainless steel of 3 & 5mm thickness
- Made by high quality material
- Low installation and maintenance cost
- Automatic ignition
- Controls the temperature of the boiler/furnace
- Gradual increase of the burner's power in 3 steps
- Three ways of operation : single, continuous, analogue
- Photosensor for controlling the fire, by measuring the flame's density.
- Thermostat protecting the burner of overheating and back fire
- Connection for STB sensor, for overheating furnace/ boiler
- Detecting possible malfunction of the temperature's sensors
- Automatic restart of the burner after power failure
- High combustion efficiency >95%
- Low emissions CO, NOx.
- The controller is separated from the burner for increased safety
- High quality connector connecting controller with the burner

Megatherm

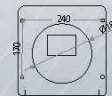
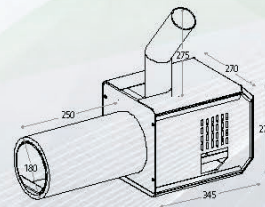

| | |
|--------------------------|------------------------------------|
| Type | MPB 80 |
| Power | 40 - 80 kW 34.400 - 68.800 Kcal |
| Length | 595 mm |
| Width | 270 mm |
| Height with drop pipe | 550 mm |
| Height without drop pipe | 275 mm |
| Fire tube diameter | Ø 180 mm |
| Power supply | 230 Volt / 50 Hz |
| Igniter | 425 Watt |
| Electr. Consumption | 40-70 Watt (approx.) |
| Fuel | Wood pellet 6-8mm, A' Class |
| Weight | 19 kg |
| Feeder's length | 1,5 m |

* Included on delivery: Burner MPB 50, electronic controller, feeder 1,5m, plastic pipe connecting the burner with the feeder, scrapper

Megatherm



MPB 150 Pro

- Ideal for large buildings agricultural and industrial applications
- It can be installed in bakery oven, space heaters, steam boilers, wood/pellet boilers, driers, car's pint shops, etc.
- Double wall fire tube (tube-in-tube) made by high heat resistance stainless steel of 3 & 5mm thickness
- The feeding system is consisted of 2 feeders (the external and the internal feeder)
- Made by high quality material
- Low installation and maintenance cost
- Automatic ignition
- Controls the temperature of the boiler/furnace
- Gradual increase of the burner's power in 3 steps
- Three ways of operation : single, continuous, analogue
- Photosensor for controlling the fire, by measuring the flame's density.
- Thermostat protecting the burner of overheating and back fire
- Connection for STB sensor, for overheating furnace/ boiler
- Detecting possible malfunction of the temperature's sensors
- Automatic restart of the burner after power failure
- High combustion efficiency >95%
- Low emissions CO, NOx.
- The controller is separated from the burner for increased safety
- High quality connector connecting controller with the burner

| | |
|--------------------------|--------------------------------------|
| Type | MPB 150 Pro |
| Power | 70 - 150 kW 60.200 - 129.000 Kcal |
| Length | 815 mm |
| Width | 360 mm |
| Height with drop pipe | 540 mm |
| Height without drop pipe | 420 mm |
| Fire tube diameter | Φ 204 mm |
| Power supply | 230 Volt / 50 Hz |
| Igniter | 425 Watt |
| Electr. Consumption | 70-80 Watt (approx.) |
| Fuel | Wood pellet 6-8mm, A' Class |
| Weight | 40 kg |
| Feeder's length | 2 m |

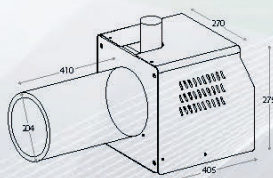

* Included on delivery: Burner MPB 150 Pro, electronic controller, feeder 2m, plastic pipe connecting the burner with the feeder, scrapper

MPB 250 Pro

Megatherm

- Ideal for large buildings agricultural and industrial applications
- It can be installed in bakery oven, space heaters, steam boilers, wood/pellet boilers, driers, car's pint shops, etc.
- Double wall fire tube (tube-in-tube) made by high heat resistance stainless steel of 3 & 5mm thickness
- The feeding system is consisted of 2 feeders (the external and the internal feeder)
- Made by high quality material
- Low installation and maintenance cost
- Automatic ignition
- Controls the temperature of the boiler/furnace
- Gradual increase of the burner's power in 3 steps
- Three ways of operation : single, continuous, analogue
- Photosensor for controlling the fire, by measuring the flame's density.
- Thermostat protecting the burner of overheating and back fire
- Connection for STB sensor, for overheating furnace/ boiler
- Detecting possible malfunction of the temperature's sensors
- Automatic restart of the burner after power failure
- High combustion efficiency >95%
- Low emissions CO, NOx.
- The controller is separated from the burner for increased safety
- High quality connector connecting controller with the burner

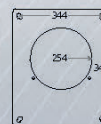
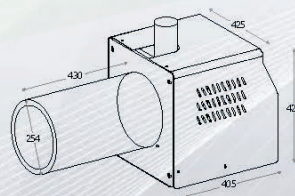
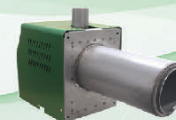

| | |
|--------------------------|---------------------------------------|
| Type | MPB 250 Pro |
| Power | 100 - 250 kW 86.000 - 215.000 Kcal |
| Length | 835 mm |
| Width | 425 mm |
| Height with drop pipe | 540 mm |
| Height without drop pipe | 420 mm |
| Fire tube diameter | Ø 254 mm |
| Power supply | 230 Volt / 50 Hz |
| Igniter | 425 Watt |
| Electr. Consumption | 70-80 Watt (approx.) |
| Fuel | Wood pellet 6-8mm, A' Class |
| Weight | 45 kg |
| Feeder's length | 2 m |

* Included on delivery: Burner MPB 250 Pro, electronic controller, feeder 2m, plastic pipe connecting the burner with the feeder, scrapper

Manufacturer:

Megatherm

Vassilika, Thessaloniki,
57006, Greece

Tel: +30 23960 23437

Fax: +30 23960 23247

web www.megatherm.gr

email info@megatherm.gr

Facebook. www.facebook.com/megathermGR

Dealer:

